



Let **UK** Home

**2 Bedrooms**

**Flat**

**Located in London**

**£2,750 Per Month**



[info@letukhome.co.uk](mailto:info@letukhome.co.uk)

<https://www.letukhome.co.uk/>

01795 358 886



# 42 Brook Avenue, Wembley London

HA9 8FX



Let UK Home are excited to offer this two-bedroom apartment in Pullman House, located at 42 Brook Avenue in the vibrant area of Wembley.

This property comprises a large bright open plan kitchen and living room leading to a large private balcony with great views, two double bedrooms with wardrobes (master en-suite), a large family sized bathroom and ample storage. A virtual viewing is provided.

One of the standout features of Pullman House is the exceptional service provided by the 12-hour concierge, ensuring your needs are met with ease. Residents can also take advantage of a roof terrace with panoramic views of the surrounding area.

For families, the location is particularly appealing, with several Ofsted-rated 'Outstanding' primary and secondary schools nearby, making it an excellent choice for those with children. Commuters will appreciate the convenience of Wembley Park Station, just a short walk away, providing direct access to Central London in a few minutes via the Jubilee and Metropolitan lines.

# 42 Brook Avenue, Wembley London

£2,750 Per Month



- 8th Floor
- Roof Terrace
- Bike Storage
- EPC Rating: B
- Concierge Service
- Private Balcony
- Virtual Viewing Available



# PULLMAN HOUSE

2 BEDROOM APARTMENT

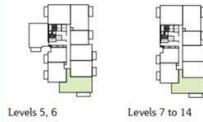

Floor	Plot
20	
19	
18	
17	
16	
15	
14	412
13	404
12	396
11	388
10	380
9	372
8	364
7	356
6	348
5	339
4	
3	
2	
1	
G	

**Living/Kitchen/Dining**  
19'4" x 13'0" (5892 x 3951mm)

**Bedroom 1**  
12'8" x 11'3" (3863 x 3423mm)

**En suite**  
7'3" x 5'1" (2200 x 1550mm)

**Bedroom 2**  
8'2" x 10'11" (2500 x 3324mm)

**Bathroom**  
7'3" x 6'9" (2200 x 2050mm)

**TOTAL AREA**  
767 ft<sup>2</sup> (71 m<sup>2</sup>)

**Balcony**  
18'1" x 5'1" (5503 x 1550mm)

**Council Tax Band: D**

**Local Authority:**

Agents Note: Whilst every care has been taken to prepare these particulars, they are for guidance purposes only. All measurements are approximate and are for general guidance purposes only and whilst every care has been taken to ensure their accuracy, they should not be relied upon and potential buyers/tenants are advised to recheck the measurements.



Let **UK** Home

3F 2 Eastbourne Terrace  
Paddington  
London  
W2 6LG

01795 358 886

info@letukhome.co.uk

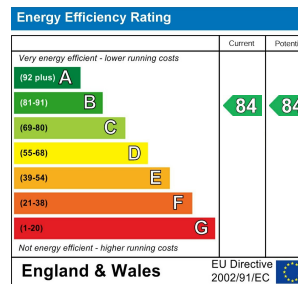

<https://www.letukhome.co.uk/>